



## TIG 200

### TIG 200

Equipment as supplied:

- Electrode holder: Ø 2.4 mm
- Gas nozzle: Ø 11 mm, size 7
- Tungsten electrode E3 (purple): Ø 2.4 mm

- Gas-cooled TIG welding torch
- Ergonomic GRIP handle for a secure grip

<b>Duty cycle DC-</b>	200 A / 35 %
<b>Duty cycle AC</b>	140 A / 35 %
<b>Electrode Ø</b>	1.6 mm - 3.2 mm
<b>Gas flow</b>	10 l/min - 20 l/min

### TIG 200 GRIP GD



- Double push-button 

**Connection** Tichel, 5-pole

Designation		Item no.		
	m			
TIG welding torch, gas-cooled	4	394-510981-00600		
	8	394-510981-00608		

### TIG 200 GRIP GD EZA



- Euro torch connector for operation on Picomig, Taurus, Phoenix and alpha Q (except alpha Q 330)
- Single-push button

**Connection** Euro torch connector

Designation		Item no.		
	m			
TIG welding torch, Euro torch connector	4	394-510981-04000		
	8	394-510981-04008		

### TIG 200 GRIP GD U/D



- Setting of welding current and programs 
- For Picotig AC/DC, Ietrix DC and AC/DC
- An 8-pole connection socket is required for portable machines up to 270 A

**Connection** Burndy, 8-pole

Designation		Item no.		
	m			
TIG welding torch, up/down, gas-cooled	4	394-510981-00200		
	8	394-510981-00208		



■ Consumables

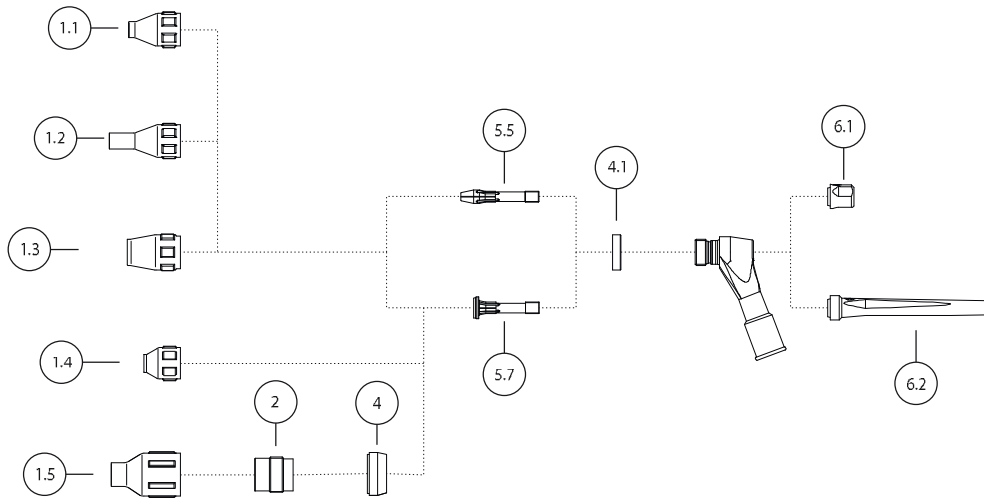

► You will find other spare parts in our spare parts catalogue.

Item	Designation	Size	Electrode Ø mm	Nozzle Ø mm	Length mm	Material	PU Pc.	Item no.
1.1	Gas nozzle	5	-	7.5	37	Ceramic	10	094-009646-00000
1.1	Gas nozzle	6	-	10	37	Ceramic	10	094-009647-00000
1.1	Gas nozzle	8	-	13	37	Ceramic	10	094-009648-00000
1.1	Gas nozzle	10	-	15	37	Ceramic	10	094-009649-00000
1.2	Gas nozzle	5	-	7.5	52	Ceramic	10	094-009650-00000
1.2	Gas nozzle	6	-	10	52	Ceramic	10	094-009651-00000
1.2	Gas nozzle	8	-	13	52	Ceramic	10	094-009653-00000
1.2	Gas nozzle	10	-	15	52	Ceramic	10	094-009654-00000
1.3	Gas nozzle, reinforced	8	-	13	38.4	Ceramic	10	094-011997-00000
1.3	Gas nozzle, reinforced	12	-	15	38.4	Ceramic	10	094-011998-00000
1.4	Gas nozzle for gas diffuser	4	-	10	26	Ceramic	10	094-009655-00000
1.4	Gas nozzle for gas diffuser	6	-	13	26	Ceramic	10	094-009656-00000
1.5	Gas nozzle for gas diffuser, JUMBO	12	-	12.5	50	Ceramic	10	094-009663-00000
1.5	Gas nozzle for gas diffuser, JUMBO	16	-	16	50	Ceramic	10	094-009664-00000
1.5	Gas nozzle for gas diffuser, JUMBO	20	-	19.5	50	Ceramic	10	094-009665-00000
2	Gas diffuser, JUMBO	-	1.6	-	-	Brass	1	094-009658-00000
2	Gas diffuser, JUMBO	-	2.4	-	-	Brass	1	094-009659-00000
2	Gas diffuser, JUMBO	-	3.2	-	-	Brass	1	094-009660-00000
2	Gas diffuser, JUMBO	-	4	-	-	Brass	1	094-009661-00000
4	Insulator, JUMBO	XL	-	-	-	Teflon	1	094-009657-00000
4.1	Insulator	Standard	-	-	-	Teflon	10	094-011759-00000
5.5	Electrode holders	-	1.6	-	56	Brass	5	094-009634-00000
5.5	Electrode holders	-	2.4	-	56	Brass	5	094-009636-00000
5.5	Electrode holders	-	3.2	-	56	Brass	5	094-009637-00000
5.5	Electrode holders	-	4	-	56	Brass	5	094-009638-00000
5.7	Gas diffuser	-	1.6	-	47	Brass	2	094-009640-00000
5.7	Gas diffuser	-	2.4	-	47	Brass	2	094-009642-00000
5.7	Gas diffuser	-	3.2	-	47	Brass	2	094-009643-00000
5.7	Gas diffuser	-	4	-	47	Brass	2	094-009644-00000
6.1	Back cap	short	-	-	-	Plastic	5	094-010723-00000
6.2	Back cap	long	-	-	-	Plastic	5	094-010601-00000

Product details

Tungsten electrodes

Consumables kits for TIG series

Page

264

267