



**MT301G**

**MT301G**

Equipment ex works (steel wire):

- Gas nozzle Ø 15 mm; 71 mm
- Gas diffuser Ø 17 mm; 14 mm
- Contact tip M9 x 35 mm; Ø 1.0 mm and contact tip holder M9 x 34.5 mm
- Steel liner, blue; Ø 1.5 mm x 3.8 mm

- Gas-cooled MIG/MAG welding torch
- Equipped for 1.0 mm welding wire (steel)

<b>Duty cycle CO2</b>	330 A / 60 %
<b>Duty cycle M21</b>	300 A / 60 %
<b>Duty cycle M21 pulse</b>	210 A / 60 %
<b>Wire Ø</b>	0.8 mm - 1.6 mm
<b>Gas flow</b>	10 l/min - 20 l/min
<b>Connection</b>	Euro torch connector
<b>Thread, contact tip</b>	M9
<b>Bend angle torch neck</b>	45 °

**MT301G**



Designation	m	Item no.		
MIG/MAG welding torch, gas-cooled	M9	3	094-500055-00000	
		4	094-500055-00004	
		5	094-500055-00005	



Designation	Item no.		
Conversion kit, upper torch trigger	092-007829-00500		



■ Consumables

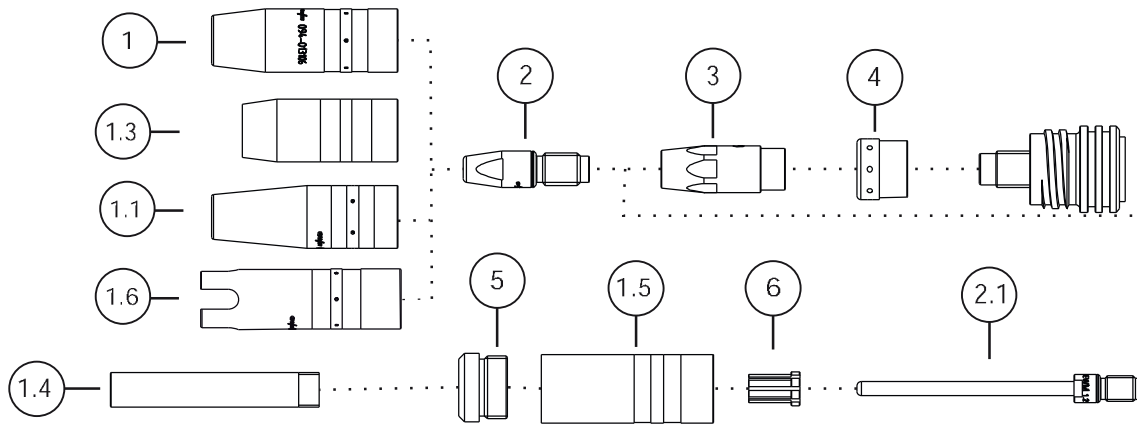

► Euro torch connector ex works. Other connectors on request.

► You will find other spare parts in our spare parts catalogue.

Item	Designation	Nozzle Ø mm	Wire Ø mm	Threads	Length mm	Material	PU Pc.	Item no.
1	Gas nozzle	13	-	-	71	-	10	094-013105-00001
1	Gas nozzle	15	-	-	71	-	10	094-013106-00001
1	Gas nozzle	18	-	-	71	-	10	094-013107-00001
1.1	Gas nozzle, very conical, narrow gap welding	13	-	-	71	-	10	094-019853-00001
1.3	Gas nozzle, Innershield	-	-	-	59.5	-	10	094-019554-00000
1.4	Gas nozzle, narrow gap welding	-	-	-	73	-	10	094-019626-00000
1.5	Gas nozzle body	-	-	-	-	-	10	094-019623-00000
1.6	Spot gas nozzle	20	-	-	80	-	10	094-020945-00000
2	Contact tip	-	0.8	M9	35	CuCrZr	10	094-013528-00000
2	Contact tip	-	0.9	M9	35	CuCrZr	10	094-013529-00000
2	Contact tip	-	1	M9	35	CuCrZr	10	094-013530-00000
2	Contact tip	-	1.2	M9	35	CuCrZr	10	094-013531-00000
2	Contact tip	-	1.4	M9	35	CuCrZr	10	094-013532-00000
2	Contact tip	-	1.6	M9	35	CuCrZr	10	094-013533-00000
2	Contact tip, aluminium welding	-	0.8	M9	35	E-Cu	10	094-013543-00000
2	Contact tip, aluminium welding	-	0.9	M9	35	E-Cu	10	094-013544-00000
2	Contact tip, aluminium welding	-	1	M9	35	E-Cu	10	094-013545-00000
2	Contact tip, aluminium welding	-	1.2	M9	35	E-Cu	10	094-013546-00000
2	Contact tip, aluminium welding	-	1.4	M9	35	E-Cu	10	094-013547-00000
2	Contact tip, aluminium welding	-	1.6	M9	35	E-Cu	10	094-013548-00000
2.1	Contact tip, narrow gap welding	-	0.8	M9	100	CuCrZr	10	094-021189-00000
2.1	Contact tip, narrow gap welding	-	1	M9	100	CuCrZr	10	094-019616-00000
2.1	Contact tip, narrow gap welding	-	1.2	M9	100	CuCrZr	10	094-019617-00000
2.1	Contact tip, narrow gap welding	-	1.4	M9	100	CuCrZr	10	094-020019-00000
2.1	Contact tip, narrow gap welding	-	1.6	M9	100	CuCrZr	10	094-019618-00000
3	Contact tip holder	-	-	M9	34.5	CuCrZr	10	094-013539-00002
3	Contact tip holder	-	-	M9	37.5	CuCrZr	10	094-013540-00002
4	Gas diffusers	-	-	-	-	Plastic	10	094-013096-00002
5	Capillary tube	-	-	-	-	-	1	094-019625-00000
6	Centring sleeve	-	-	-	-	-	10	094-019627-00000
-	Torch key, SW5/12MM	-	-	-	-	-	1	094-016038-00001

Product details

Steel liners / Liners

Consumables kits for MT series

Adapters

Page

233

240

243