

DATA SHEET

TIG 260 GRIP WD 5P 8m

394-510990-00608



- Water-cooled TIG welding torch
- Double push-button
- Ergonomic GRIP handle for a secure hold and ergonomic use
- 5-pole connection socket required on machine side
- In case an 8-pole welding machine is being used, the "ADAP 8-5 POL" adapter can be alternatively used
- Excellent HF safety

Configurations	Standard
Duty cycle DC-	260 A / 100 %
Duty cycle AC	185 A / 100 %
Electrode Ø	1 mm - 3.2 mm
Connection poles	Tuchel, 5-pole
Torch connection	Decentral 35 mm ² (pin Ø 13 mm ²)
Control cable connection	Tuchel, 5-pole
Shielding gas supply	G 1/4" RH, crown nut
Hose package length	8 m
Test mark	CE UK EAC

DATA SHEET

Consumables

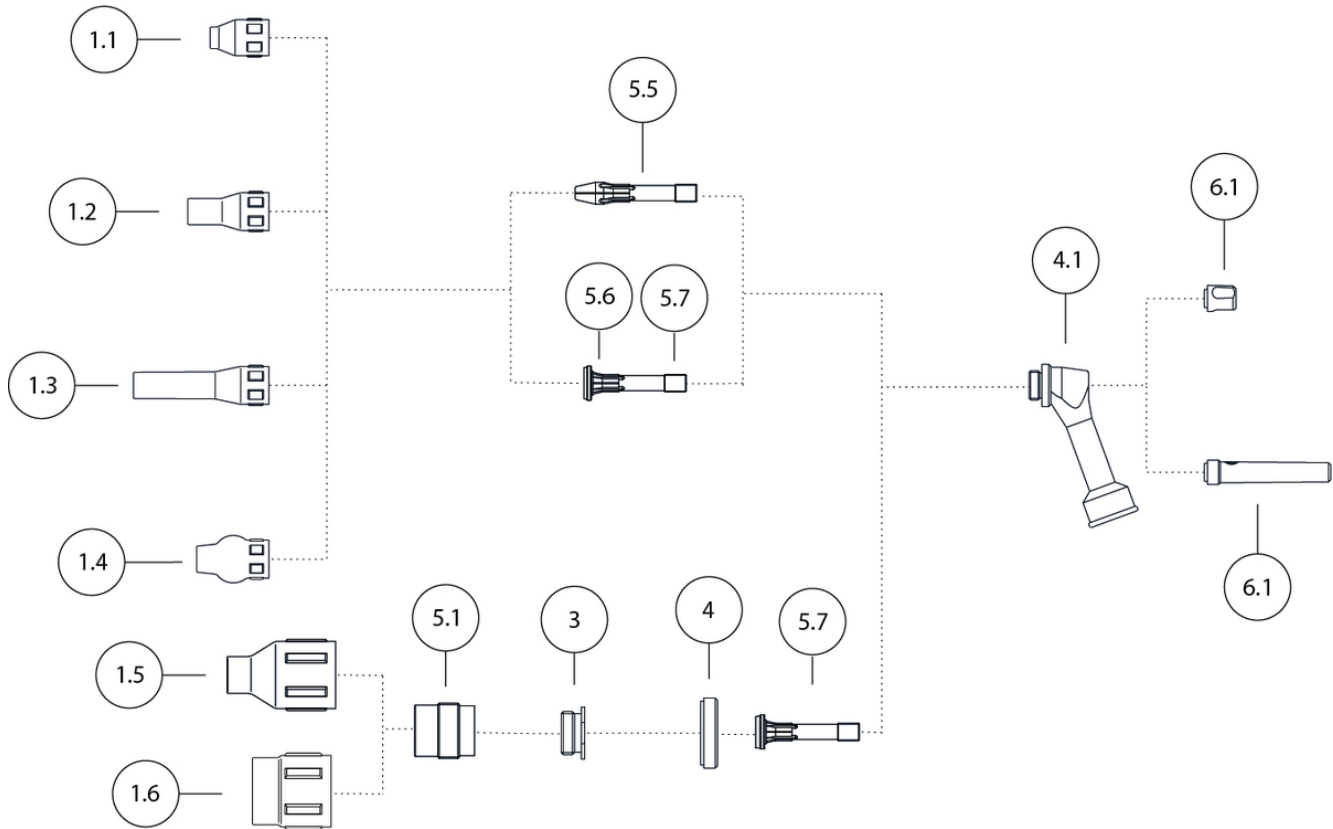

Item	Item no.	Designation
1.1	094-012672-00000	GN TIG 150/260 S 6.5x26mm. Gas nozzle
1.1	094-011980-00000	GN TIG 150/260 S 11.5x26mm. Gas nozzle
1.1	094-012405-00000	GN TIG 150/260 S 8.0x26mm. Gas nozzle
1.1	094-011756-00000	GN TIG 150/260 S 9,5x26mm. Gas nozzle
1.2	094-012673-00000	GN TIG 150/260 6.5x36mm. Gas nozzle
1.2	094-012674-00000	GN TIG 150/260 8.0x36mm. Gas nozzle
1.2	094-011982-00000	GN TIG 150/260 10x36mm. Gas nozzle
1.2	094-011757-00000	GN TIG 150/260 11.5x36mm. Gas nozzle
1.3	094-015451-00000	GN 150/260 6.5x60mm. Gas nozzle
1.3	398-000191-00000	GN 150/260 8x60mm. Gas nozzle
1.4	094-019609-00000	GN TIG 150/260 11x32mm. Gas nozzle, ball-shape design
1.4	394-000156-00000	GN TIG 150/260 8x32mm. Gas nozzle, ball-shape design
1.4	394-000155-00000	GN TIG 150/260 9,5x32mm. Gas nozzle, ball-shape design
1.4	094-019610-00000	GN TIG 150/260 6,5x32mm. Gas nozzle, ball-shape design
1.5	094-009665-00000	GN DIF TIG 150-450/450SC, 19,5 x 50 mm. Gas nozzle for gas diffuser, JUMBO
1.5	094-009664-00000	GN DIF TIG 150-450/450SC, 16 x 50 mm. Gas nozzle for gas diffuser, JUMBO
1.5	094-009663-00000	GN DIF TIG 150-450/450SC, 12,5 x 50 mm. Gas nozzle for gas diffuser, JUMBO
1.6	094-011999-00000	GN TIG Ø 24 mm, L 34 mm. Gas nozzle for gas diffuser, JUMBO
3	094-011758-00000	ADAPT 150/260 XL. Adapter ring, JUMBO
4	094-011760-00000	ISO TIG 150/260 XL. Insulator, JUMBO
4.1	094-011979-00000	ISO TIG 150/260. Insulator
5.1	094-023022-00000	DIF TIG 150-450/450SC Multilayer Ø 4.0 mm. Gas diffuser, multi-layer
5.1	094-023021-00000	DIF TIG 150-450/450SC Multilayer Ø 3.2 mm. Gas diffuser, multi-layer
5.1	094-022685-00000	DIF TIG 150-450/450SC Multilayer Ø 2.4 mm. Gas diffuser, multi-layer
5.1	094-009660-00000	DIF TIG 150-450/450SC Ø 3.2mm. Gas diffuser, JUMBO
5.1	094-009659-00000	DIF TIG 150-450/450SC Ø 2.4mm. Gas diffuser, JUMBO

Item	Item no.	Designation
5.1	094-009658-00000	DIF TIG 150-450/450SC Ø 1,6mm. Gas diffuser, JUMBO
5.1	094-023020-00000	DIF TIG 150-450/450SC Multilayer Ø 1.6 mm. Gas diffuser, multi-layer
5.5	094-011755-00000	COL 150/260 Ø 2.4x35mm. Electrode holder
5.5	094-012667-00000	COL 150/260 Ø 3.2x35mm. Electrode holder
5.5	094-012665-00000	COL 150/260 Ø 1.0x35mm. Electrode holder
5.5	094-012406-00000	COL 150/260 Ø 1.6x35mm. Electrode holder
5.6	094-023030-00000	CDIF TIG 150/260 Multilayer 1.0 mm. Gas diffuser, multi-layer
5.6	394-002358-00000	CDIF TIG 150/260 Multilayer 3.2 mm. Gas diffuser, multi-layer
5.6	394-002038-00000	CDIF TIG 150/260 Multilayer 2.4 mm. Gas diffuser, multi-layer
5.6	394-002357-00000	CDIF TIG 150/260 Multilayer 1.6 mm. Gas diffuser, multi-layer
5.7	094-012668-00000	COL DIF 150/260 1.0x33mm. Gas diffuser
5.7	094-012669-00000	COL DIF 150/260 1.6x33mm. Gas diffuser
5.7	094-011984-00000	COL DIF 150/260 2.4x33mm. Gas diffuser
5.7	094-012671-00000	COL DIF 150/260 3.2x33mm. Gas diffuser
6.1	094-011753-00000	TCM TIG 150/260. Back cap, medium
6.1	094-011752-00000	TCS TIG 150/260. Back cap, short
-	094-001011-00000	WP; 4,0 x 175 mm. Tungsten electrode, green
-	094-014912-00000	Lymox Ø1.0 x 175 mm. Tungsten electrode, pink
-	094-019694-00000	E3; 2,4 x 175 mm. Tungsten electrode, purple
-	094-019695-00000	E3; 3,2 x 175 mm. Tungsten electrode, purple
-	094-019696-00000	E3; 4,0 x 175 mm. Tungsten electrode, purple
-	094-001009-00000	WP; 2,4 x 175 mm. Tungsten electrode, green
-	094-001594-00000	WP; 2,0 x 175 mm. Tungsten electrode, green
-	094-001008-00000	WP; 1,6 x 175 mm. Tungsten electrode, green
-	094-001593-00000	WP; 1,0 x 175 mm. Tungsten electrode, green
-	092-015252-00000	TIG 150/260. Replacement parts set
-	094-014915-00000	Lymox Ø2.4 x 175 mm. Tungsten electrode, pink
-	094-014913-00000	Lymox Ø1.6 x 175 mm. Tungsten electrode, pink
-	094-014914-00000	Lymox Ø2.0 x 175 mm. Tungsten electrode, pink
-	094-019692-00000	E3; 1,6 x 175 mm. Tungsten electrode, purple
-	094-008412-00000	Lymox Ø3.2 x 175 mm. Tungsten electrode, pink
-	094-008413-00000	Lymox Ø4.0 x 175 mm. Tungsten electrode, pink
-	094-014916-00000	Lymox Ø4.8 x 175 mm. Tungsten electrode, pink
-	094-021496-00000	Lymox Lux Ø1.0 x 175 mm. Tungsten electrode, pink/grey
-	094-021497-00000	Lymox Lux Ø1.6 x 175 mm. Tungsten electrode, pink/grey
-	094-021498-00000	Lymox Lux Ø2.4 x 175 mm. Tungsten electrode, pink/grey
-	094-021499-00000	Lymox Lux Ø3.2 x 175 mm. Tungsten electrode, pink/grey
-	094-021500-00000	Lymox Lux Ø4.0 x 175 mm. Tungsten electrode, pink/grey
-	094-021501-00000	Lymox Lux Ø4.8 x 175 mm. Tungsten electrode, pink/grey
-	094-019693-00000	E3; 2,0 x 175 mm. Tungsten electrode, purple
-	094-019691-00000	E3; 1,0 x 175 mm. Tungsten electrode, purple
-	094-001595-00000	WP; 4,8 x 175 mm. Tungsten electrode, green
-	094-009312-00000	WR 02; 4,0 x 175 mm. Tungsten electrode, turquoise
-	094-001380-00000	WCe 20; 1,0 x 175 mm. Tungsten electrode, grey
-	094-001004-00000	WCe 20; 1,6 x 175 mm. Tungsten electrode, grey
-	094-001381-00000	WCe 20; 2,0 x 175 mm. Tungsten electrode, grey
-	094-001005-00000	WCe 20; 2,4 x 175 mm. Tungsten electrode, grey
-	094-001006-00000	WCe 20; 3,2 x 175 mm. Tungsten electrode, grey
-	094-001007-00000	WCe 20; 4,0 x 175 mm. Tungsten electrode, grey
-	094-001382-00000	WCe 20; 4,8 x 175 mm. Tungsten electrode, grey
-	094-012957-00000	WR 02; 1,0 x 175 mm. Tungsten electrode, turquoise

Item	Item no.	Designation
-	094-001591-00000	WR 02; 1.6 x 175 mm. Tungsten electrode, turquoise
-	094-001010-00000	WP; 3.2 x 175 mm. Tungsten electrode, green
-	094-001592-00000	WR 02; 2.4 x 175 mm. Tungsten electrode, turquoise
-	094-001913-00000	WR 02; 3.2 x 175 mm. Tungsten electrode, turquoise
-	094-001914-00000	WR 02; 4.8 x 175 mm. Tungsten electrode, turquoise
-	094-009529-00000	WLa 15; 4.8 x 175 mm. Tungsten electrode, gold
-	094-012958-00000	WLa 20; 1.0 x 175 mm. Tungsten electrode, blue
-	094-001915-00000	WLa 20; 1.6 x 175 mm. Tungsten electrode, blue
-	094-012960-00000	WLa 20; 2.0 x 175 mm. Tungsten electrode, blue
-	094-001916-00000	WLa 20; 2.4 x 175 mm. Tungsten electrode, blue
-	094-001917-00000	WLa 20; 3.2 x 175 mm. Tungsten electrode, blue
-	094-012961-00000	WLa 20; 4.0 x 175 mm. Tungsten electrode, blue
-	094-001918-00000	WLa 20; 4.8 x 175 mm. Tungsten electrode, blue
-	094-009446-00000	WLa 15; 1.0 x 175 mm. Tungsten electrode, gold
-	094-009447-00000	WLa 15; 1.6 x 175 mm. Tungsten electrode, gold
-	094-012962-00000	WLa 15; 2.0 x 175 mm. Tungsten electrode, gold
-	094-009276-00000	WLa 15; 2.4 x 175 mm. Tungsten electrode, gold
-	094-009527-00000	WLa 15; 3.2 x 175 mm. Tungsten electrode, gold
-	094-009528-00000	WLa 15; 4.0 x 175 mm. Tungsten electrode, gold
-	094-002136-00000	WR 02; 2.0 x 175 mm. Tungsten electrode, turquoise