

DATA SHEET

TIG 450 GRIP WD 8P U/D 4m

394-510993-00200



- Water-cooled TIG welding torch
- Setting the welding current
- Ergonomic GRIP handle for a secure hold and ergonomic use
- Suitable for machines from the Tetrax-DC and AC/DC series as well as Picotig 200 AC/DC
- 8-pole connection socket required on machine side
- Excellent HF safety

Configurations	Standard
Duty cycle DC-	400 A / 100 %
Duty cycle AC	280 A / 100 %
Electrode Ø	1.6 mm - 4.8 mm
Connection poles	Burndy, 8-pole
Torch connection	Decentral 35 mm ² (pin Ø 13 mm ²)
Control cable connection	Burndy, 8-pole
Shielding gas supply	G 1/4" RH, crown nut
Hose package length	4 m
Test mark	CE UK EAC

DATA SHEET

Consumables

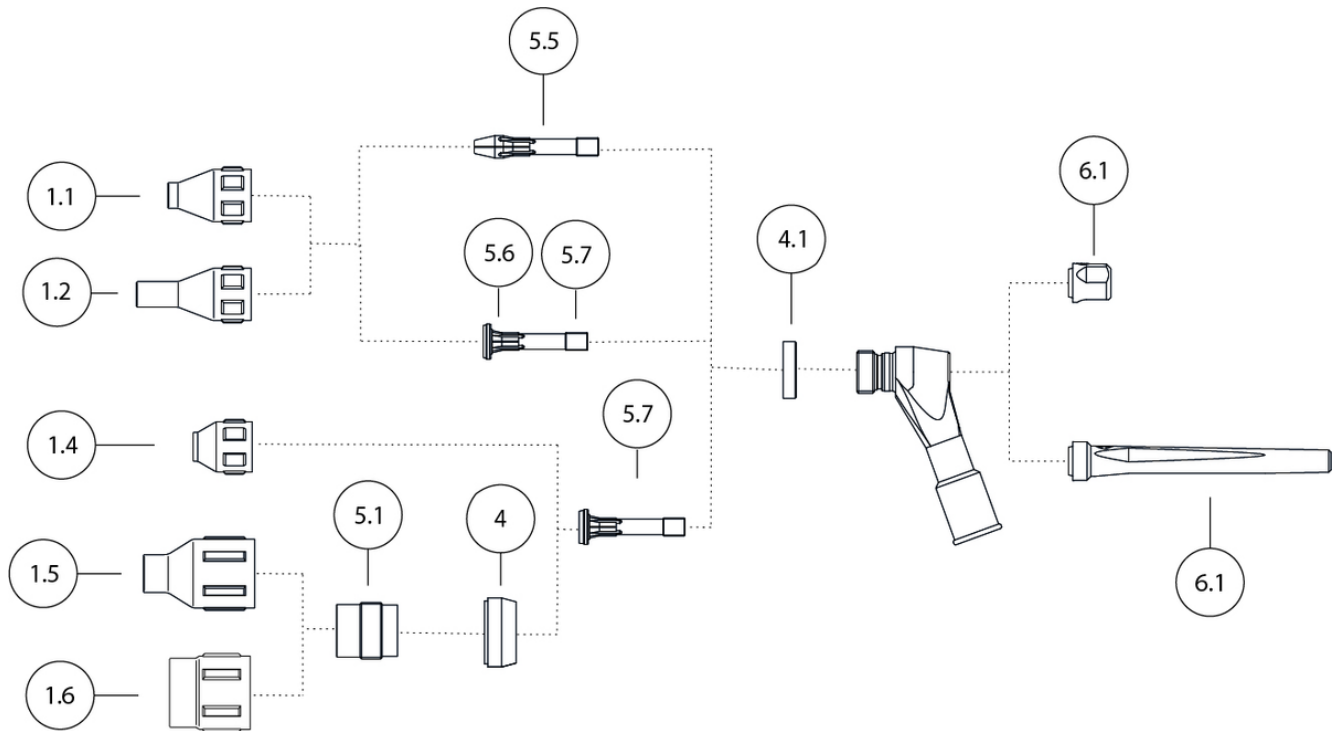

Item	Item no.	Designation
1.1	094-009646-00000	GN TIG 200/450/450SC, 7,5 x 37,4 mm. Gas nozzle
1.1	094-009648-00000	GN TIG 200/450/450SC, 13 x 37,4 mm. Gas nozzle
1.1	094-009649-00000	GN TIG 200/450/450SC, 15 x 37,4 mm. Gas nozzle
1.1	094-011997-00000	GN TIG 200/450 13.0x37mm RF. Gas nozzle, reinforced
1.1	094-011998-00000	GN TIG 200/450 15.0x37mm RF. Gas nozzle, reinforced
1.1	094-009647-00000	GN TIG 200/450/450SC, 10 x 37,4 mm. Gas nozzle
1.2	094-009650-00000	GN TIG 200/450/450SC, 7,5 x 51,5 mm. Gas nozzle
1.2	094-009651-00000	GN TIG 200/450/450SC, 10 x 51,5 mm. Gas nozzle
1.2	094-009653-00000	GN TIG 200/450/450SC, 13 x 51,5 mm. Gas nozzle
1.2	094-009654-00000	GN TIG 200/450/450SC, 15 x 51,5 mm. Gas nozzle
1.4	094-009655-00000	GN TIG 200/450 S 10.0x26mm. Gas nozzle for gas diffuser
1.4	094-009656-00000	GN TIG 200/450 S 13.0x26mm. Gas nozzle for gas diffuser
1.5	094-009663-00000	GN DIF TIG 150-450/450SC, 12,5 x 50 mm. Gas nozzle for gas diffuser, JUMBO
1.5	094-009665-00000	GN DIF TIG 150-450/450SC, 19,5 x 50 mm. Gas nozzle for gas diffuser, JUMBO
1.5	094-009664-00000	GN DIF TIG 150-450/450SC, 16 x 50 mm. Gas nozzle for gas diffuser, JUMBO
1.6	094-011999-00000	GN TIG Ø 24 mm, L 34 mm. Gas nozzle for gas diffuser, JUMBO
4	094-009657-00000	INS TIG 200/450 JUMBO. Insulator, JUMBO
4.1	094-011759-00000	INS TIG 200/450/450SC. Insulator
5.1	094-009661-00000	DIF TIG 150-450/450SC, D=4,0 mm. Gas diffuser, JUMBO
5.1	094-009660-00000	DIF TIG 150-450/450SC Ø 3.2mm. Gas diffuser, JUMBO
5.1	094-022685-00000	DIF TIG 150-450/450SC Multilayer Ø 2.4 mm. Gas diffuser, multi-layer
5.1	094-023021-00000	DIF TIG 150-450/450SC Multilayer Ø 3.2 mm. Gas diffuser, multi-layer
5.1	094-023022-00000	DIF TIG 150-450/450SC Multilayer Ø 4.0 mm. Gas diffuser, multi-layer
5.1	094-009658-00000	DIF TIG 150-450/450SC Ø 1,6mm. Gas diffuser, JUMBO
5.1	094-009659-00000	DIF TIG 150-450/450SC Ø 2,4mm. Gas diffuser, JUMBO
5.1	094-023020-00000	DIF TIG 150-450/450SC Multilayer Ø 1,6 mm. Gas diffuser, multi-layer
5.5	094-009634-00000	COL 200/450 1.6x56mm. Electrode holder
5.5	094-009636-00000	COL 200/450 2.4x56mm. Electrode holder
5.5	094-009637-00000	COL 200/450 3.2x56mm. Electrode holder

Item	Item no.	Designation
5.5	094-009638-00000	COL 200/450 4.0x56mm. Electrode holder
5.6	094-006255-00000	200/450/SC Multilayer Ø 3.2 mm. Gas diffuser, multi-layer
5.6	094-004969-00000	200/450/SC Multilayer Ø 2.4 mm. Gas diffuser, multi-layer
5.6	094-023018-00000	200/450/SC Multilayer Ø 1.6 mm. Gas diffuser, multi-layer
5.7	094-009640-00000	COL DIF TIG 200/450/450SC 1.6x48mm. Gas diffuser
5.7	094-009644-00000	COL DIF TIG 200/450/450SC 4.0x48mm. Gas diffuser
5.7	094-009643-00000	COL DIF TIG 200/450/450SC 3.2x48mm. Gas diffuser
5.7	094-009642-00000	COL DIF TIG 200/450/450SC 2.4x48mm. Gas diffuser
6.1	094-010723-00000	TCS TIG 200/450/450SC. Back cap, short
6.1	094-010601-00000	TCL TIG 200/450. Back cap, long
-	094-019694-00000	E3; 2,4 x 175 mm. Tungsten electrode, purple
-	094-019696-00000	E3; 4,0 x 175 mm. Tungsten electrode, purple
-	094-019693-00000	E3; 2,0 x 175 mm. Tungsten electrode, purple
-	094-019692-00000	E3; 1,6 x 175 mm. Tungsten electrode, purple
-	094-019691-00000	E3; 1,0 x 175 mm. Tungsten electrode, purple
-	094-009529-00000	WLa 15; 4,8 x 175 mm. Tungsten electrode, gold
-	094-009528-00000	WLa 15; 4,0 x 175 mm. Tungsten electrode, gold
-	094-019695-00000	E3; 3,2 x 175 mm. Tungsten electrode, purple
-	094-008412-00000	Lymox Ø3.2 x 175 mm. Tungsten electrode, pink
-	094-014912-00000	Lymox Ø1.0 x 175 mm. Tungsten electrode, pink
-	094-014913-00000	Lymox Ø1.6 x 175 mm. Tungsten electrode, pink
-	094-014914-00000	Lymox Ø2.0 x 175 mm. Tungsten electrode, pink
-	094-014915-00000	Lymox Ø2.4 x 175 mm. Tungsten electrode, pink
-	094-008413-00000	Lymox Ø4.0 x 175 mm. Tungsten electrode, pink
-	094-014916-00000	Lymox Ø4.8 x 175 mm. Tungsten electrode, pink
-	094-021496-00000	Lymox Lux Ø1.0 x 175 mm. Tungsten electrode, pink/grey
-	094-021497-00000	Lymox Lux Ø1.6 x 175 mm. Tungsten electrode, pink/grey
-	094-021498-00000	Lymox Lux Ø2.4 x 175 mm. Tungsten electrode, pink/grey
-	094-021499-00000	Lymox Lux Ø3.2 x 175 mm. Tungsten electrode, pink/grey
-	094-009276-00000	WLa 15; 2,4 x 175 mm. Tungsten electrode, gold
-	094-021500-00000	Lymox Lux Ø4.0 x 175 mm. Tungsten electrode, pink/grey
-	094-009527-00000	WLa 15; 3,2 x 175 mm. Tungsten electrode, gold
-	094-001591-00000	WR 02; 1.6 x 175 mm. Tungsten electrode, turquoise
-	094-012962-00000	WLa 15; 2,0 x 175 mm. Tungsten electrode, gold
-	094-001007-00000	WCe 20; 4,0 x 175 mm. Tungsten electrode, grey
-	092-015251-00000	TIG 200/450. Replacement parts set
-	094-001593-00000	WP; 1,0 x 175 mm. Tungsten electrode, green
-	094-001008-00000	WP; 1,6 x 175 mm. Tungsten electrode, green
-	094-001594-00000	WP; 2,0 x 175 mm. Tungsten electrode, green
-	094-001009-00000	WP; 2,4 x 175 mm. Tungsten electrode, green
-	094-001010-00000	WP; 3,2 x 175 mm. Tungsten electrode, green
-	094-001011-00000	WP; 4,0 x 175 mm. Tungsten electrode, green
-	094-001595-00000	WP; 4,8 x 175 mm. Tungsten electrode, green
-	094-001380-00000	WCe 20; 1,0 x 175 mm. Tungsten electrode, grey
-	094-001004-00000	WCe 20; 1,6 x 175 mm. Tungsten electrode, grey
-	094-001381-00000	WCe 20; 2,0 x 175 mm. Tungsten electrode, grey
-	094-001005-00000	WCe 20; 2,4 x 175 mm. Tungsten electrode, grey
-	094-001006-00000	WCe 20; 3,2 x 175 mm. Tungsten electrode, grey
-	094-001382-00000	WCe 20; 4,8 x 175 mm. Tungsten electrode, grey
-	094-009447-00000	WLa 15; 1,6 x 175 mm. Tungsten electrode, gold
-	094-012957-00000	WR 02; 1,0 x 175 mm. Tungsten electrode, turquoise

Item	Item no.	Designation
-	094-002136-00000	WR 02; 2.0 x 175 mm. Tungsten electrode, turquoise
-	094-001592-00000	WR 02; 2.4 x 175 mm. Tungsten electrode, turquoise
-	094-001913-00000	WR 02; 3.2 x 175 mm. Tungsten electrode, turquoise
-	094-009312-00000	WR 02; 4.0 x 175 mm. Tungsten electrode, turquoise
-	094-001914-00000	WR 02; 4.8 x 175 mm. Tungsten electrode, turquoise
-	094-012958-00000	WLa 20; 1.0 x 175 mm. Tungsten electrode, blue
-	094-001915-00000	WLa 20; 1.6 x 175 mm. Tungsten electrode, blue
-	094-012960-00000	WLa 20; 2.0 x 175 mm. Tungsten electrode, blue
-	094-001916-00000	WLa 20; 2.4 x 175 mm. Tungsten electrode, blue
-	094-001917-00000	WLa 20; 3.2 x 175 mm. Tungsten electrode, blue
-	094-012961-00000	WLa 20; 4.0 x 175 mm. Tungsten electrode, blue
-	094-001918-00000	WLa 20; 4.8 x 175 mm. Tungsten electrode, blue
-	094-009446-00000	WLa 15; 1.0 x 175 mm. Tungsten electrode, gold
-	094-021501-00000	Lymox Lux Ø4.8 x 175 mm. Tungsten electrode, pink/grey