

DATA SHEET

TIG-MT 200G 3M

094-011708-00003

- Automated TIG welding torch, gas-cooled
- Long service life thanks to best heat dissipation combined with smallest possible size
- Hose package outlet on side without risk of kinking
- Tungsten electrode can be adjusted from the rear
- Clamping diameter range 26 mm



Duty cycle DC-	200 A / 60 %
Duty cycle AC	140 A / 60 %
Electrode Ø	1 mm - 4 mm
Connection	Decentral
Hose package length	3 m
Test mark	CE UK EAC

DATA SHEET

Consumables

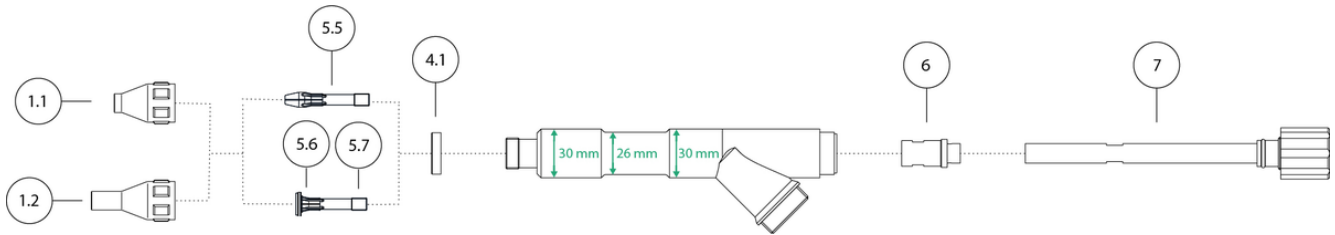

Item	Item no.	Designation
1.1	094-009646-00000	GN TIG 200/450/450SC, 7,5 x 37,4 mm. Gas nozzle
1.1	094-009648-00000	GN TIG 200/450/450SC, 13 x 37,4 mm. Gas nozzle
1.1	094-009649-00000	GN TIG 200/450/450SC, 15 x 37,4 mm. Gas nozzle
1.1	094-011997-00000	GN TIG 200/450 13.0x37mm RF. Gas nozzle, reinforced
1.1	094-011998-00000	GN TIG 200/450 15.0x37mm RF. Gas nozzle, reinforced
1.1	094-009647-00000	GN TIG 200/450/450SC, 10 x 37,4 mm. Gas nozzle
1.2	094-009650-00000	GN TIG 200/450/450SC, 7,5 x 51,5 mm. Gas nozzle
1.2	094-009651-00000	GN TIG 200/450/450SC, 10 x 51,5 mm. Gas nozzle
1.2	094-009653-00000	GN TIG 200/450/450SC, 13 x 51,5 mm. Gas nozzle
1.2	094-009654-00000	GN TIG 200/450/450SC, 15 x 51,5 mm. Gas nozzle
4.1	094-011759-00000	INS TIG 200/450/450SC. Insulator
5.5	094-009638-00000	COL 200/450 4.0x56mm. Electrode holder
5.5	094-009637-00000	COL 200/450 3.2x56mm. Electrode holder
5.5	094-009636-00000	COL 200/450 2.4x56mm. Electrode holder
5.5	094-009635-00000	COL 200/450 2.0x56mm. Electrode holder
5.5	094-009634-00000	COL 200/450 1.6x56mm. Electrode holder
5.5	094-009639-00000	COL 200/450 4.8x56mm. Electrode holder
5.6	094-023018-00000	200/450/SC Multilayer Ø 1.6 mm. Gas diffuser, multi-layer
5.6	094-004969-00000	200/450/SC Multilayer Ø 2.4 mm. Gas diffuser, multi-layer
5.6	094-006255-00000	200/450/SC Multilayer Ø 3.2 mm. Gas diffuser, multi-layer
5.7	094-009645-00000	COL DIF TIG 200/450/450SC 4.8x48mm. Gas diffuser
5.7	094-009642-00000	COL DIF TIG 200/450/450SC 2.4x48mm. Gas diffuser
5.7	094-009643-00000	COL DIF TIG 200/450/450SC 3.2x48mm. Gas diffuser
5.7	094-009644-00000	COL DIF TIG 200/450/450SC 4.0x48mm. Gas diffuser
5.7	094-009641-00000	COL DIF TIG 200/450/450SC 2.0x48mm. Gas diffuser
5.7	094-009640-00000	COL DIF TIG 200/450/450SC 1.6x48mm. Gas diffuser
6	094-020286-00000	COLB DIF TIG-MT 200/300. Mount for guide tube
7	094-020285-00000	TG TIG-MT 200G/300W. Guide tube
-	094-009527-00000	WLa 15; 3.2 x 175 mm. Tungsten electrode, gold
-	094-012961-00000	WLa 20; 4.0 x 175 mm. Tungsten electrode, blue
-	094-001918-00000	WLa 20; 4.8 x 175 mm. Tungsten electrode, blue
-	094-009446-00000	WLa 15; 1.0 x 175 mm. Tungsten electrode, gold
-	094-009447-00000	WLa 15; 1.6 x 175 mm. Tungsten electrode, gold
-	094-012962-00000	WLa 15; 2.0 x 175 mm. Tungsten electrode, gold
-	094-009276-00000	WLa 15; 2.4 x 175 mm. Tungsten electrode, gold
-	094-019692-00000	E3; 1,6 x 175 mm. Tungsten electrode, purple
-	094-009528-00000	WLa 15; 4,0 x 175 mm. Tungsten electrode, gold
-	094-009529-00000	WLa 15; 4,8 x 175 mm. Tungsten electrode, gold
-	094-019691-00000	E3; 1,0 x 175 mm. Tungsten electrode, purple
-	094-001916-00000	WLa 20; 2,4 x 175 mm. Tungsten electrode, blue
-	094-019693-00000	E3; 2,0 x 175 mm. Tungsten electrode, purple
-	094-019694-00000	E3; 2,4 x 175 mm. Tungsten electrode, purple
-	094-019695-00000	E3; 3,2 x 175 mm. Tungsten electrode, purple

Item	Item no.	Designation
-	094-019696-00000	E3; 4,0 x 175 mm. Tungsten electrode, purple
-	094-001917-00000	WLa 20; 3.2 x 175 mm. Tungsten electrode, blue
-	094-012958-00000	WLa 20; 1.0 x 175 mm. Tungsten electrode, blue
-	094-012960-00000	WLa 20; 2.0 x 175 mm. Tungsten electrode, blue
-	094-001378-00000	WTh 20; 2.0 x 175 mm. Tungsten electrode, red
-	094-001593-00000	WP; 1.0 x 175 mm. Tungsten electrode, green
-	094-001008-00000	WP; 1.6 x 175 mm. Tungsten electrode, green
-	094-001594-00000	WP; 2.0 x 175 mm. Tungsten electrode, green
-	094-001009-00000	WP; 2.4 x 175 mm. Tungsten electrode, green
-	094-001010-00000	WP; 3.2 x 175 mm. Tungsten electrode, green
-	094-001011-00000	WP; 4.0 x 175 mm. Tungsten electrode, green
-	094-001595-00000	WP; 4.8 x 175 mm. Tungsten electrode, green
-	094-001377-00000	WTh 20; 1.0 x 175 mm. Tungsten electrode, red
-	094-001000-00000	WTh 20; 1.6 x 175 mm. Tungsten electrode, red
-	094-001001-00000	WTh 20; 2.4 x 175 mm. Tungsten electrode, red
-	094-001915-00000	WLa 20; 1.6 x 175 mm. Tungsten electrode, blue
-	094-001002-00000	WTh 20; 3.2 x 175 mm. Tungsten electrode, red
-	094-001379-00000	TERED 4.8x175mm. Tungsten electrode, red
-	094-001380-00000	WCe 20; 1.0 x 175 mm. Tungsten electrode, grey
-	094-001004-00000	WCe 20; 1.6 x 175 mm. Tungsten electrode, grey
-	094-001381-00000	WCe 20; 2.0 x 175 mm. Tungsten electrode, grey
-	094-001005-00000	WCe 20; 2.4 x 175 mm. Tungsten electrode, grey
-	094-001006-00000	WCe 20; 3.2 x 175 mm. Tungsten electrode, grey
-	094-001007-00000	WCe 20; 4.0 x 175 mm. Tungsten electrode, grey
-	094-001382-00000	WCe 20; 4.8 x 175 mm. Tungsten electrode, grey
-	094-001003-00000	WTh 20; 4.0 x 175 mm. Tungsten electrode, red